

N1/4 COR. SEC. 19
T. 17N., R. 19E., W.M.
S.P. 93-14

NE COR. SEC. 19
T. 17N., R. 19E., W.M.
FND. 3" KITTITAS CO.
B.C. IN CASED MON.
VISITED 06/07/2018

LEGAL DESCRIPTION

PARCEL 142836 (TRACT 1) (existing description)
Parcel A of that certain Survey recorded April 22, 1993, in Book 19 of Surveys, Page 73, under Auditor's File No. 558819; being a portion of the North Half of the Northeast 1/4 of Section 19, Township 17 North, Range 19 East, W.M., in the County of Kittitas, State of Washington;

AND
Lots 1 and 2, as delineated on Redd Short Plat No. 93-14, recorded January 19, 1994, in Book "D" of Short Plats, Pages 89 and 90, under Auditor's File No. 567251; being a portion of the Northeast 1/4 of Section 19, Township 17 North, Range 19 East, W.M., in the County of Kittitas, State of Washington; EXCEPT that portion of the Northeast 1/4 of Section 19, Township 17 North, Range 19 East, W.M., in the County of Kittitas, State of Washington, which is bounded by a line described as follows: Beginning at the Northwest corner of Parcel A of that certain Survey recorded April 22, 1993, in Book 19 of Surveys, Page 73, under Auditor's File No. 558819, which is the true point of beginning for said described line; thence Southerly, along the West boundary of said Parcel A, which is also the East right-of-way boundary I-82, to the South boundary of said North Half of the Northeast 1/4, thence N87°58'34"E, along said South boundary of said North Half of the Northeast 1/4, 60.81 feet to the centerline of Naneum Creek; thence Northeasterly, along said Naneum Creek centerline, to the North boundary of said North Half of the Northeast 1/4, thence S87°42'10"W, along said North boundary, 763.52 feet to the true point of beginning for said described line;

AND EXCEPT that portion of the Northeast 1/4 of Section 19, Township 17 North, Range 19 East, W.M., in the County of Kittitas, State of Washington, described as follows:
Beginning at the Northeast corner of Lot 2 of the REDD SHORT PLAT as per short plat thereof, filed in Book D of Short Plats, pages 89 and 90, under Auditor's File No. 567251, records of said county; thence S01°11'57"E, along the East boundary of said Lot 2, 287.91 feet to the true point of beginning; thence continuing along said East boundary, S01°11'57"E, 284.48 feet; thence N86°53'19"W, 482.06 feet; thence N00°43'38"W, 297.41 feet; thence S85°19'53"E, 480.76 feet, more or less, to the true point of beginning

PARCEL 312836 (TRACT 2) (existing description)
That portion of Lot 2, of REDD SHORT PLAT, as described and/or delineated on Kittitas County Short Plat No. 93-14, as recorded January 19, 1994, in Book D of Short Plats, pages 89 and 90, under Auditor's File No. 567251, records of Kittitas County, State of Washington; being a portion of the Northeast 1/4 of Section 19, Township 17 North, Range 19 East, W.M., in the County of Kittitas, State of Washington, described as follows:
Beginning at the Northeast corner of said Lot 2; thence S01°11'57"E, along the East boundary of said Lot 2, 287.91 feet to the true point of beginning; thence continuing along said East boundary S01°11'57"E, 284.48 feet; thence N86°53'19"W, 482.06 feet, thence N00°43'38"W, 297.41 feet; thence S85°19'53"E, 480.76 feet, more or less, to the true point of beginning

PARCEL 10402 (TRACT 3) (existing description)
Parcel B-2 of that certain Survey recorded August 2, 1993, in Book 19 of Surveys, Page 111, under Auditor's File No. 561859, records of Kittitas County, Washington, being a portion of the North Half of the Northeast 1/4 of Section 19, Township 17 North, Range 19 East, W.M., in the County of Kittitas, State of Washington

NEW DESCRIPTIONS

TRACT 1

TRACT 1, as shown, on that certain Record of Survey recorded in Book 41 of Surveys, Page 188, under Auditor's File No. 201810050030, records of Kittitas County, Washington, being a portion of Parcel A of that certain Survey recorded April 22, 1993, in Book 19 of Surveys, Page 73, under Auditor's File No. 558819, and a portion of Lots 1 and 2, of Short Plat No. 93-14, recorded January 19, 1994, in Book "D" of Short Plats, Pages 89 and 90, under Auditor's File No. 56725, and a portion of Parcel B-2 of that certain Survey recorded August 2, 1993, in Book 19 of Surveys, Page 111, under Auditor's File No. 561859, all records of Kittitas County, Washington.

TRACT 2

TRACT 2, as shown, on that certain Record of Survey recorded in Book 41 of Surveys, Page 188, under Auditor's File No. 201810050030, records of Kittitas County, Washington, being a portion of Lots 1 and 2, of Short Plat No. 93-14, recorded January 19, 1994, in Book "D" of Short Plats, Pages 89 and 90, under Auditor's File No. 56725, records of Kittitas County, Washington.

TRACT 3

TRACT 3, as shown, on that certain Record of Survey recorded in Book 41 of Surveys, Page 188, under Auditor's File No. 201810050030, records of Kittitas County, Washington, being a portion of Lots 1 and 2, of Short Plat No. 93-14, recorded January 19, 1994, in Book "D" of Short Plats, Pages 89 and 90, under Auditor's File No. 56725, and Parcel B-2 of that certain Survey recorded August 2, 1993, in Book 19 of Surveys, Page 111, under Auditor's File No. 561859, all records of Kittitas County, Washington.

GRAPHIC SCALE

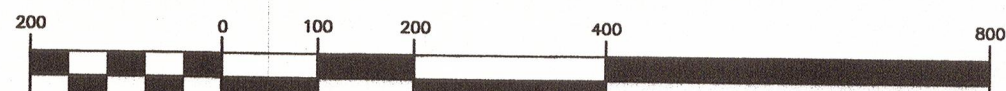

(IN FEET)
1 inch = 200 ft.

CENTER SEC. 19
T. 17N., R. 19E., W.M.
S.P. 93-14

E1/4 COR. SEC. 19
T. 17N., R. 19E., W.M.
FND. 2" KITTITAS CO.
AL. CAP IN CASED MON.
VISITED 06/07/2018

LINE TABLE		
LINE#	LENGTH	BEARING
L1	289.44	N01°11'57"W
L2	50.00	N87°58'34"E
L3	100.00	N01°11'57"W
L4	28.88	N87°58'34"E



EQUIPMENT AND PROCEDURES USED:
a: 5 SEC. EDM TOTAL STATION
b: FIELD TRAVERSE
c: MONS VISITED DATE OF SURVEY

DATE	REVISIONS

AUDITOR'S CERTIFICATE
FILED FOR RECORD THIS 5th DAY OF October 2018
AT 12:58 P.M. UNDER AUDITOR'S FILE NUMBER
201810050030

RECORDS OF KITTITAS COUNTY, WASHINGTON AT THE
REQUEST OF GSE SURVEYING

Terre Pettit COUNTY AUDITOR by S. Haggard BY DEPUTY

SURVEYOR'S CERTIFICATE
THIS MAP CORRECTLY REPRESENTS A SURVEY MADE BY ME OR UNDER MY DIRECTION IN CONFORMANCE WITH THE REQUIREMENTS OF THE SURVEY RECORDING ACT AT THE REQUEST OF LLOYD CARNEY IN JULY 2018.

[Signature] DOUGLAS G. GRAY
DATE 10-1-18

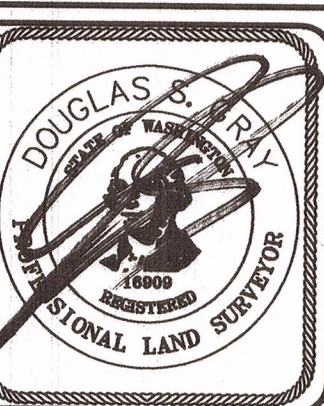

- CORNER FOUND AS NOTED
- 5/8 REBAR W/CAP #16909 SET
- ⊗ NAIL WITH WASHER SET

GSE
Gray Surveying & Engineering, Inc.
P.O. Box 510 • 2706 River Road
Yakima, Wa 98902 • (509) 575-6434

SECTION INDEXING

19

NAME **LLOYD CARNEY**
4680 4TH PARALLEL RD. ELLENSBURG, WA. 98926

LOCATION
PT N1/2 NE1/4 SEC. 19, T. 17N., R. 19E., W.M.

DRAWING TYPE
RECORD OF SURVEY

DRAWN BY: MM
CHECKED BY: D.S.G.
PROJECT NO. 18147
PARCEL NO. 10402, 142836 & 312836

SCALE: 1" = 200'
DATE: 7/12/2018
SHEET 1 OF 1